

ANALYSIS

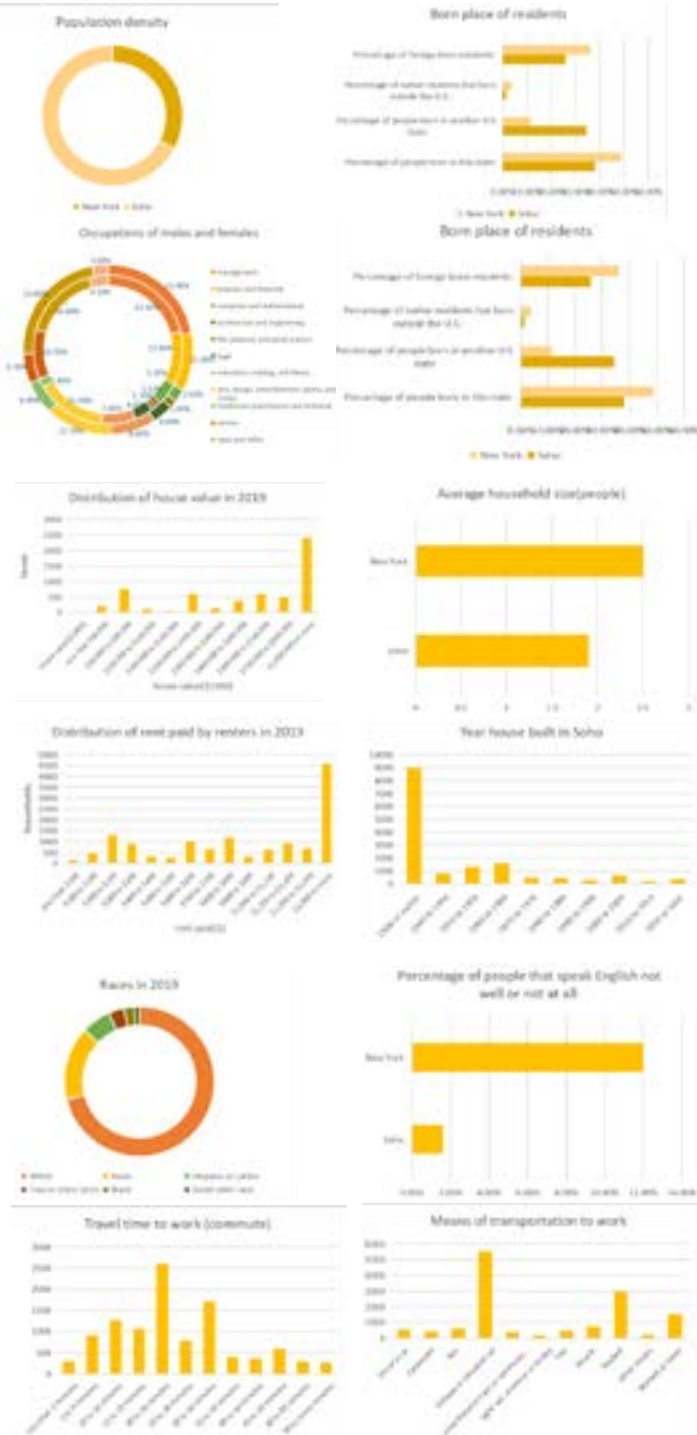
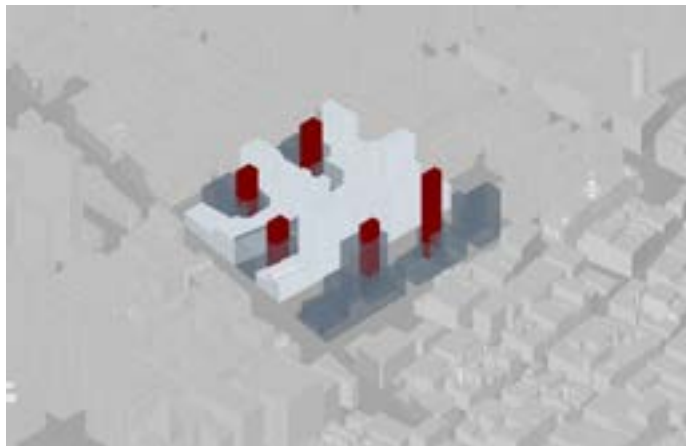

2030**construction of framework as structure and infrastructure**

We select suitable plots within the target area for the placement or addition of new complex, which will operate as the framework during development process. The structure is not only the load-bearing part of the subsequent addition, but also be inserted public functions in the internal space.

**2050****epitaxial growth of housing and top-down regeneration**

Much of the former opportunity area will be demolished to create greening area or parks just surrounding the vital tower we have completed in phase one. Affordable housing with supporting facilities should be built at suitable locations within the block in order to attract new people to enter.

**2100****community service plug-in and sky bridge**

All core tower connections, housing and supporting facilities will be all plugged in by the year of 2100. We want to use public services and affordable housing to attract diverse groups of people coming into this neighborhood, live here and work here, to mix and to breathe life into SOHO.

**possible effect when completed**