

CURRENT SITUATION



SOLUTIONS



CAR-FREE ZONE



current situation

Vienna's Ringstraße

proposal

LIGHT ANALYSIS

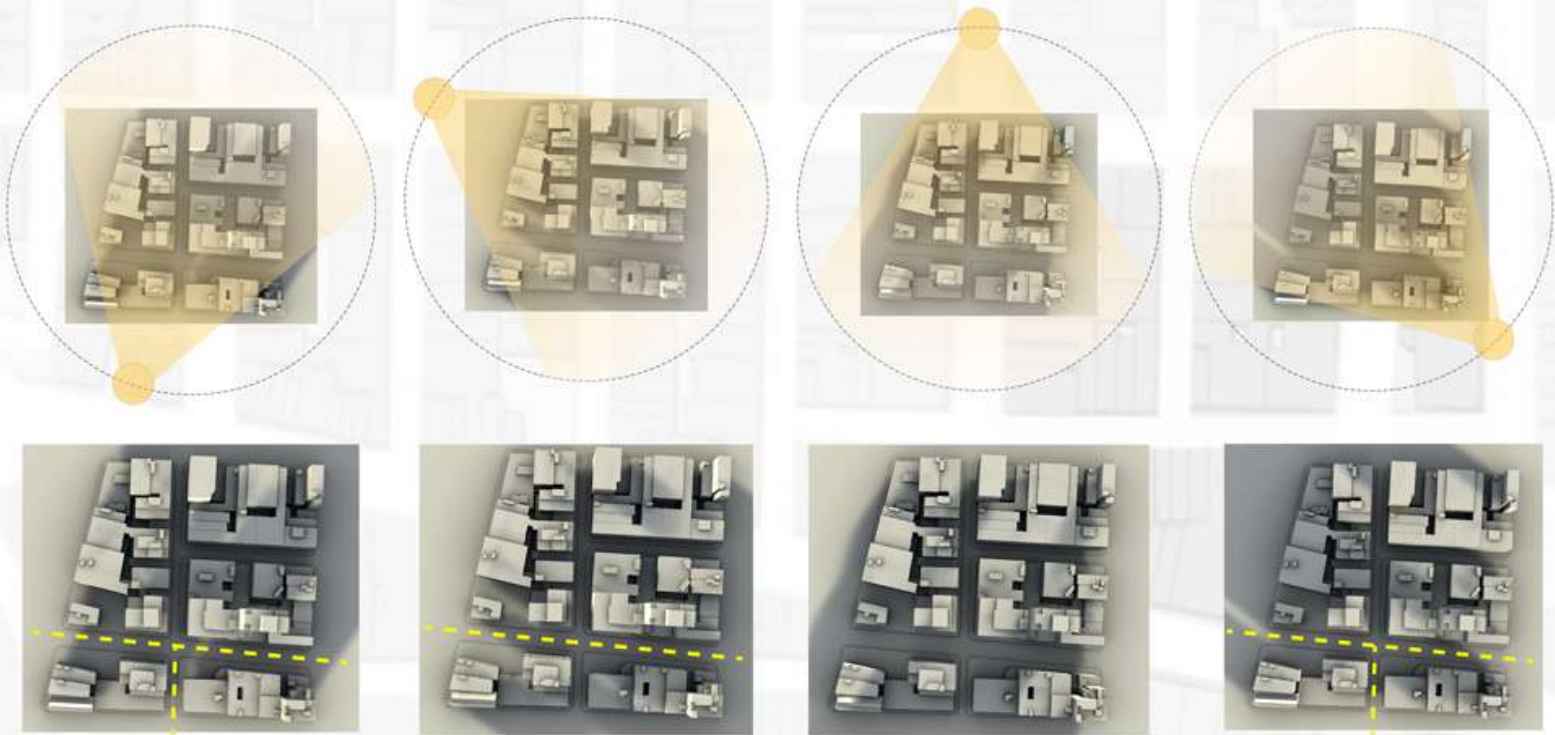



sunny street



shadow street



SHADOW STREETS
activating with activities that don't require direct light

SUNNY STREETS
green areas



SOHO REZONING.02

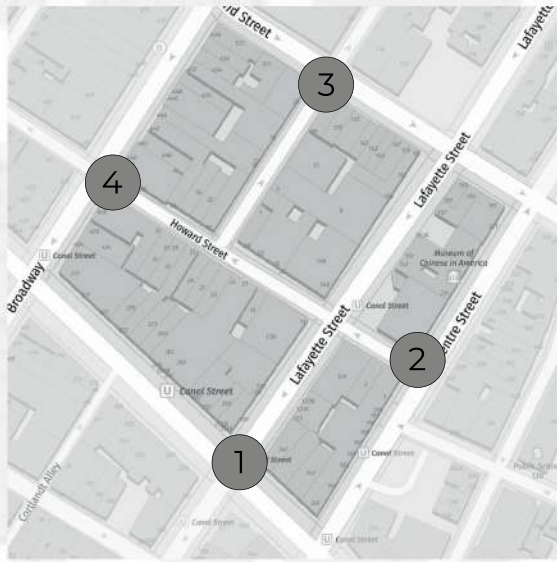

viewpoints map

Rezoning, in means of applying new infrastructural system in this area, changes the way of how traffic works and how buildings are being used. The traffic will be redirected to outside of the area in order to provide a car-free-zone within the SoHo. This way, pedestrians will get to move more free, there will be possibilities for making a green boulevards and to plan the architecture and urban places accordingly. In the matter of this fact, we based our research of the area on sun shadows. We particularly analysed the shadow coverage from Nord-East-South-West positions of the sun and managed to see, that there is one street with most of the sun in this area. On this intervals we will propose a "gray-free-zone" or as very known- green area. Trees, plant, flowers and also self manufactures are welcome. To another part, that stay in shadows most of the time, especially in lower parts of the building, there will me room planed that don't require special sun lightning, such as markets, activity rooms for sports, etc. Furthermore, there will be modular structure of living, based on three chosen zones - living, studying, activating. As in modern housing, there will be living areas (bedrooms) pushed in below of the buildings, while activating, where one spends most of the time in a day, will be pushed in the tops of the building. The learning area should be one that gets mixed in a way. The specified target group that is claimed in this spaces are going to be student. We represent modern living in sustainable architecture in order to provide the student with good price-performance-ratio. In this case apartments with a lower price/performance ratio are more desirable, excluding other factors. As a ratio it is calculated by dividing the budgeted cost of work completed, or earned value, by the actual cost of the work performed. If the ratio has a value higher than 1 then it indicates the project is performing well against the budget.

A CPI of 1 means that the project is performing on budget. Our budget are our students. There will always be many of them and this area should function like an economic circle.

IDEAL FORMULA

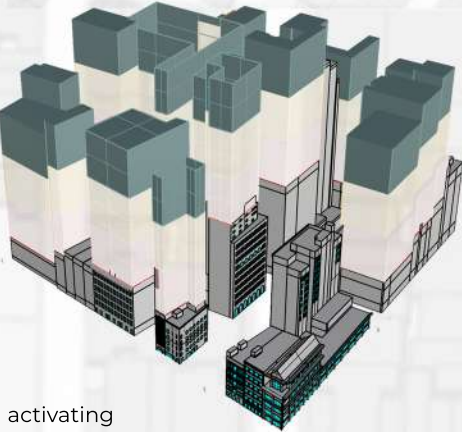
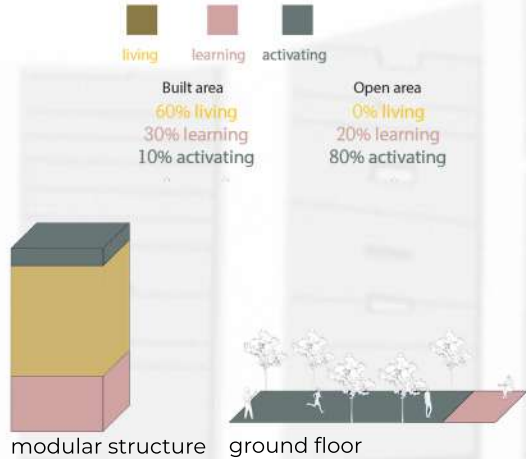

activating

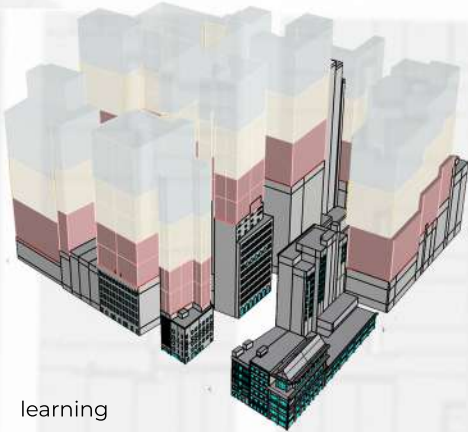

learning

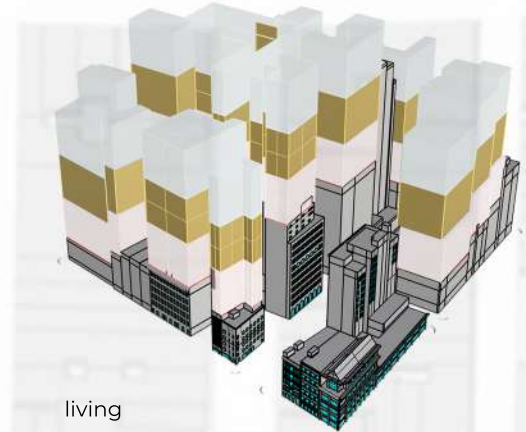

living

VERTICAL GREENERY - making green areas above the ground level

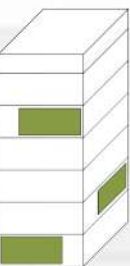

green wall

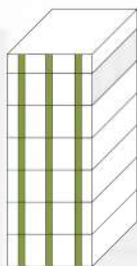

green façade

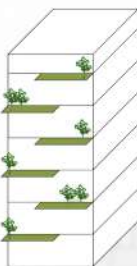

vertical forest

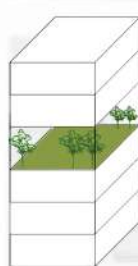

elevated forest



green roof

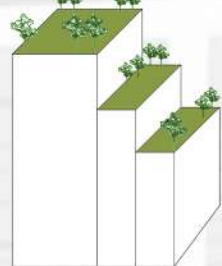

green terraces



1 - 3D view



2 - 3D view



3 - 3D view



4 - 3D view